



■ **TSTLP® Multi-RJ45 Port Surge Arrester 1000MBits/s for Network Protection**

❖ **INTRODUCTION:** Multi-RJ45 Port Surge Arrester are designed to protect network equipment from interruption caused by surge current;. Surge protective devices with 24/16/8 Ports RJ45 interface, all protected by four pairs lines protected. Designed according to IEC 61643-21; GB 18802.21; YD/T 1542. Mainly used for offices and industry like Gigabit Ethernet, ATM or ISDN system, like VOIP can be protected. (e.g. Telecom-munication server, router, computer, and so on). Module design for standard 19" distribution cabinet.

<p>TS-8RJ45/5/8 Product Photo</p>	<p>TS-8RJ45/5/8 Dimension(mm)</p>	<p>TS-8RJ45/5/8 BCD</p>
<p>TS-16RJ45/5/8 Product Photo</p>	<p>TS-16RJ45/5/8 Dimension(mm)</p>	<p>TS-16RJ45/5/8 BCD</p>
<p>TS-24RJ45/5/8 Product Photo</p>	<p>TS-24RJ45/5/8 Dimension(mm)</p>	<p>TS-24RJ45/5/8 BCD</p>

❖ **TECHNICAL DATA**

Model		TS-24RJ45/5/8/ (1000) TS-16RJ45/5/8(1000) TS-8RJ45/5/8(1000)
Nominal voltage	U _n	5V-
Rated voltage (max. continuous voltage)	U _c	6V- 4.2V~
Normal current	I _N	0.35A
Nominal discharge current (8/20)	I _n	300A (line-line) 2.5KA (line-PG)
Max. discharge current (8/20)	I _{total}	5KA (line-PG)
Voltage protection level at I _n	U _p	≤15V (line-line) ≤150V (line-PG)
Voltage protection level at 1kV/ms	U _p	≤13V (line-line) ≤150V (line-PG)
Capacitance	C	≤35pF (line-line) ≤35pF (line-PG)
Response time	t _A	≤10ns (line-line) ≤10ns (line-PG)
Max. data transmission rates	V _s	1000 Mbits/s
Dimension(mm)		L*W*H [24/16 P 484(448)*160*45mm]; 8P:168*82*41mm
Operating temperature range		-40°C...+80°C
Relative humidity		≤95% (25°C)
Connection (input / output)		RJ45 shield socket
Pining		1/2, 3/6, 4/5, 7/8
Shield earthing		Metal enclosure
Standards		IEC 61643-21; GB 18802.21; YD/T 1542
Compliance		CE(LVD,EMC)



❖ AIN CHARACTER

- ✓ Low voltage protection level & Low insertion loss
- ✓ Quick response
- ✓ Module design(4 pairs lines) for standard 19" distribution cabinet, available with 8,16,24 ports RJ45 connection.

INSTALLATION INSTRUCTION

1. This product is connected in series to the protected device.
2. Can be mounted in the 19" distribution cabinet..
3. The out terminal should be connected to the protected devices.
4. SPD's earthing terminal must be connected to nearby earthing BusBar or the metal earthing enclosure of protected device.
5. After above, you should ensure the circuit is functioning.

Regularly inspect the operating status, especially after lightning. Once the communication is off, electrician should check/replace the SPD.

TS-8RJ45/5/8 INSTALLATION DIAGRAM

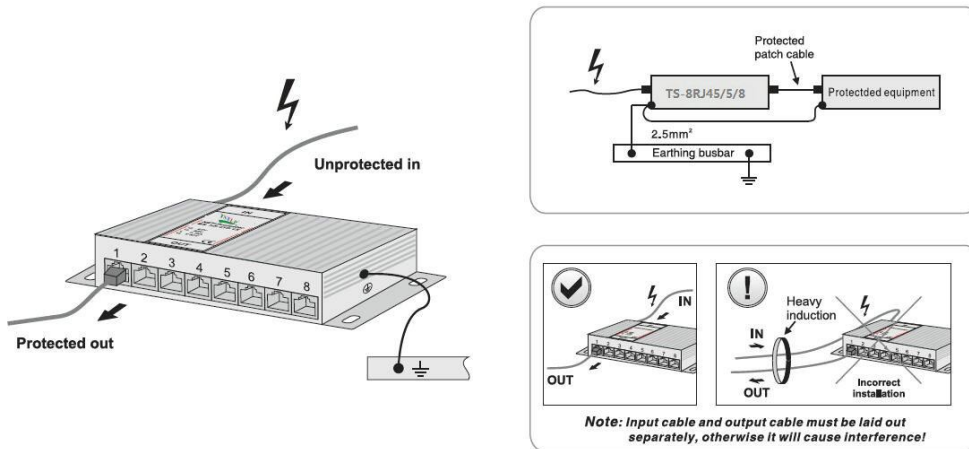

TS-16RJ45/5/8 INSTALLATION DIAGRAM

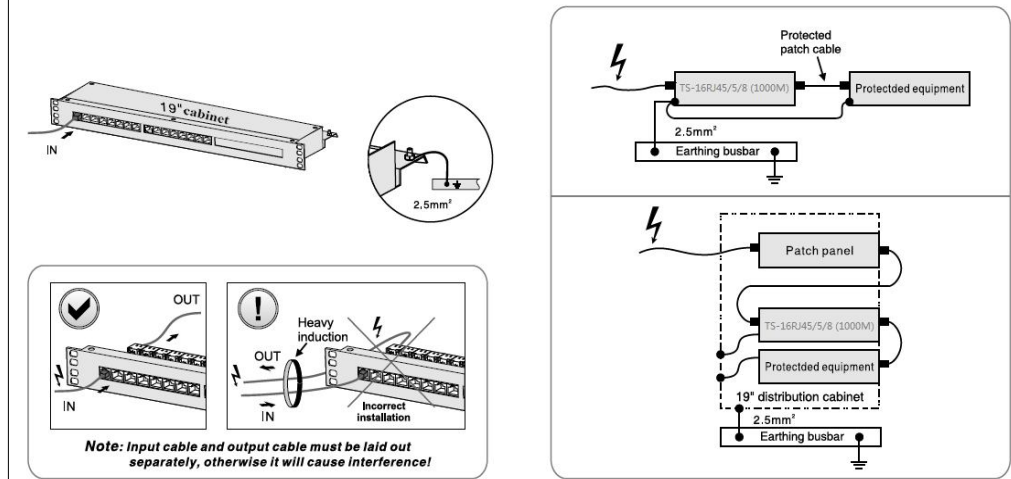

TS-24RJ45/5/8 INSTALLATION DIAGRAM

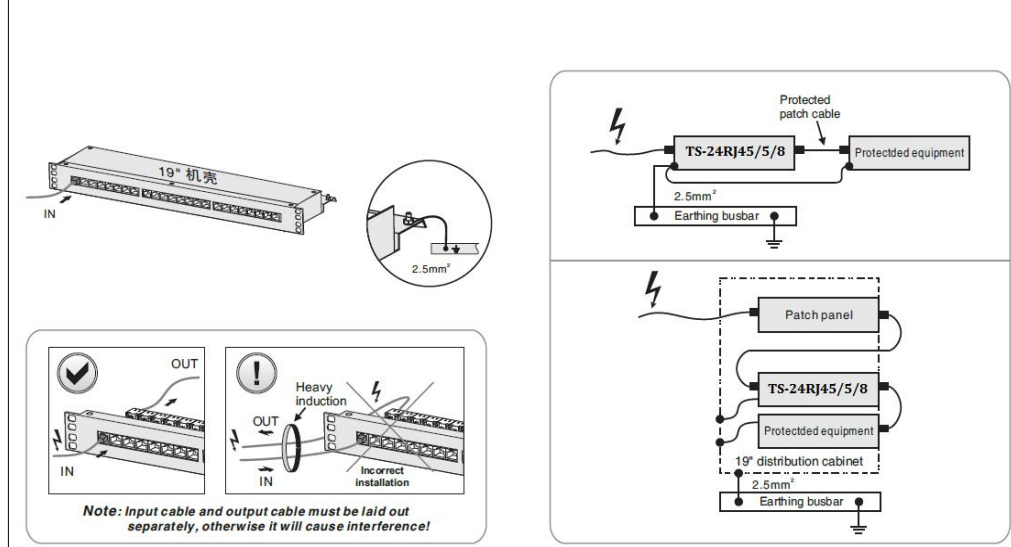

WARNING:

- The device must be installed by electrically skilled person, conforming to national standards and safety regulations.
- It is recommended that installation should be done under power off condition.